

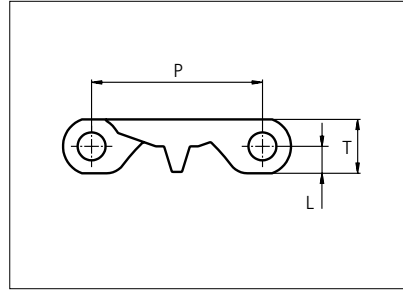

Plastic Modular Belt

Series **uni MPB** Type **16%**



Straight running belt
 Nominal pitch: 50.8 mm (2.00 in)
 Surface type: Flat
 Surface opening: 16%
 Backflex radius: 65.0 mm (2.60 in)
 Pin diameter: 8.0 mm (0.31 in)

STANDARD

Belt material & color	PP W	mm	in		mm	in	
		P (Nominal)	50.8	2.00	T	16.0	0.63
Pin material & color	PP W	L	8.0	0.31	-	-	-

Non standard material and color: See uni Material and Color Overview.

Alternative pin and lock materials: Pin: PA6.6 **N** PP **W** PE **W** PBT **LG** SS304 Lockpin: PA6.6 **B** PBT **LG** Trilock: PA6.6 **N**

Belt width		Permissible tensile force (Belt/pin material)				Belt weight (Belt/pin material)				*Min. No. drive sprocket per shaft	Number of wear strips (Min. No.)	
		PP/PP		PE-I/PE		PP/PP		PE-I/PE			**Carry (pcs)	**Return (pcs)
mm	in	N	lbf	N	lbf	Kg/m	lb/ft	Kg/m	lb/ft			
152	6.0	2432	547	1976	444	1.1	0.77	1.2	0.82	2	2	2
202	8.0	3232	727	2626	590	1.5	1.02	1.6	1.09	2	2	2
253	10.0	4048	910	3289	739	1.9	1.28	2.0	1.36	2	2	2
303	11.9	4848	1090	3939	885	2.3	1.53	2.4	1.63	3	3	2
354	13.9	5664	1273	4602	1035	2.7	1.78	2.8	1.90	3	3	2
404	15.9	6464	1453	5252	1181	3.0	2.04	3.2	2.17	3	3	2
455	17.9	7280	1637	5915	1330	3.4	2.29	3.6	2.45	4	4	2
505	19.9	8080	1816	6565	1476	3.8	2.55	4.0	2.72	4	4	2
556	21.9	8896	2000	7228	1625	4.2	2.80	4.4	2.99	4	4	2
606	23.9	9696	2180	7878	1771	4.5	3.05	4.8	3.26	5	5	3
657	25.9	10512	2363	8541	1920	4.9	3.31	5.3	3.53	5	5	3
707	27.8	11312	2543	9191	2066	5.3	3.56	5.7	3.80	5	5	3
758	29.8	12128	2726	9854	2215	5.7	3.82	6.1	4.08	6	6	3

STRAIGHT RUNNING

PITCH 50.8 MM/2.00 IN

Additional standard belt widths are available in steps of 50.3 mm (1.98 in) Additional non-standard belt widths are available in steps of 16.8 mm (0.66 in.)

1970	77.6	31520	7086	25610	5757	14.8	9.93	15.8	10.59	14	14	7
------	------	-------	------	-------	------	------	------	------	-------	----	----	---

Additional standard belt widths are available in steps of 50.3 mm (1.98 in) Additional non-standard belt widths are available in steps of 16.8 mm (0.66 in.)

2979	117,3	47664	10715	38727	8706	22,3	15,02	23,8	16,02	20	20	10
------	-------	-------	-------	-------	------	------	-------	------	-------	----	----	----

General belt tolerance is +0/-0.4% at 23°C/73°F and 50% RH. For exact belt width contact Customer Service. Non standard belt width on request.

*Max. Load per Drive Sprocket. Belt material: PP with snub roller 2000 N (450 lbf) without snub roller 1250 N (281 lbf).

**Max. Spacing between wear strips, Carry: 152.0 mm (6.00 in); Return: 304.0 mm (12.00 in)

= Single Link



Accessories

Rubber Top

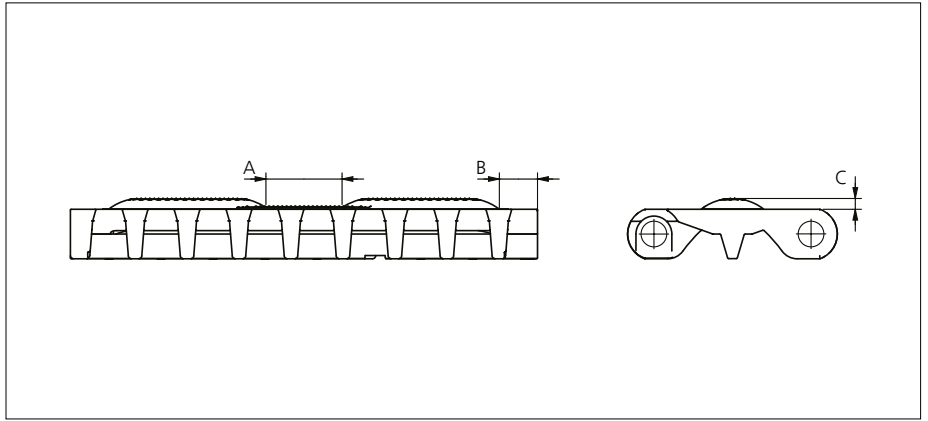

Type	Belt Material & color	Rubber Material & color	A		B		C		Link size	Width	
			mm	in	mm	in	mm	in		mm	in
Curved Rough	POM-DI W	01 N	24.0	0.94	10.0	0.39	3.5	0.14	K600	151.0	5.94

Non Standard material and color: See uni Material and Color Overview.

Accessories

Flight



See separate uni MPB series Flight datasheet.

Accessories

Side Guard

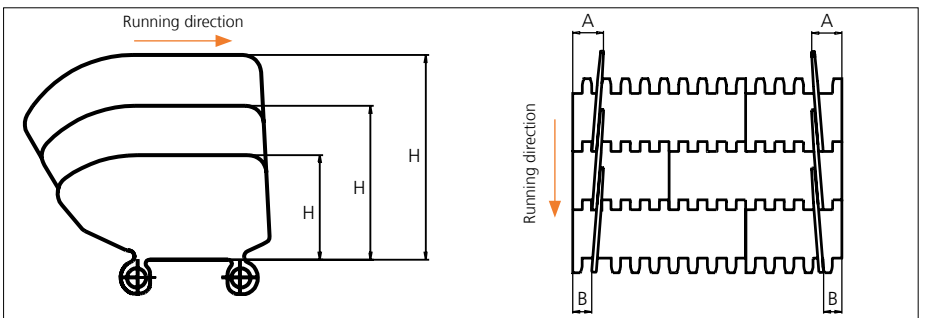

Type	Side Guard Material & color	H		A		B	
		mm	in	mm	in	mm	in
Closed	PE-I B N	50.8	2.00	32.0	1.26	16.0	0.63
	PP-I W B	76.2	3.00				
		101.6	4.00				

*34.0 mm (1.34 in) combined with flight. Increment: 8.4 mm (0.33 in).

Note: Backflex radius when Side Guards are used: 200.0 mm (7.90 in)

Accessories

Tab

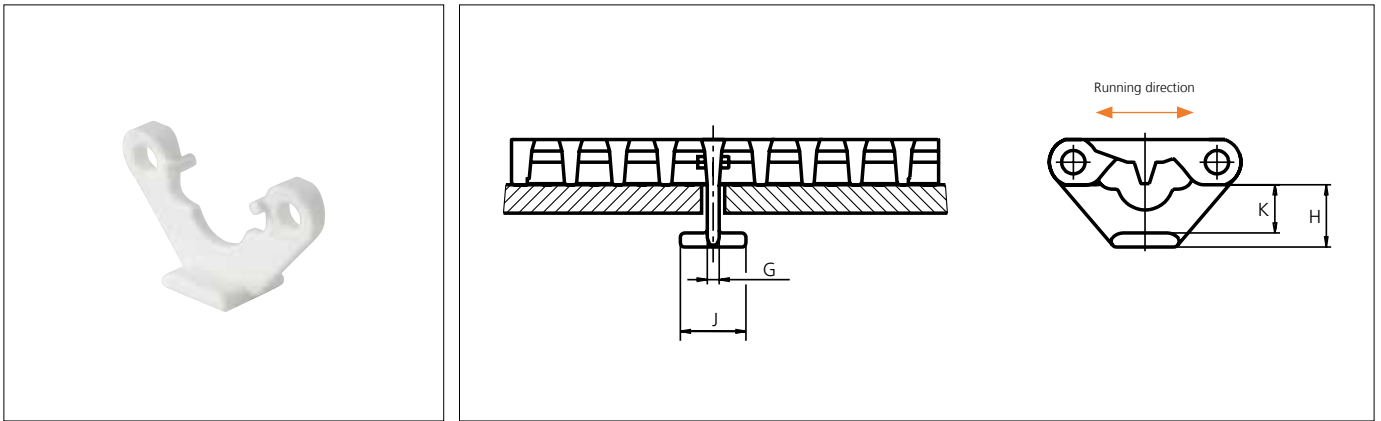

Type	Tab Material & color	G		J		K		H	
		mm	in	mm	in	mm	in	mm	in
Bottom Hold Down	POM-DI w	4.2	0.17	23.2	0.91	17.0	0.67	22.0	0.87

Note: When using tabs, please verify sufficient clearance to the shaft. Max. shaft diameter = Sprocket pitch diameter - 63.5 mm (2.50 in). When using square shafts, please verify that the diagonal does not exceed max. diameter. Example: Sprocket z = 6: Max. shaft diameter 101.6 - 63.5 = \varnothing 38.1 mm (4.00 - 2.50 = \varnothing 1.4 in).

Note: When using a belt system with tabs, the temperature should be constant. Please note that the tabs are not always placed in the middle of the belt.

Non Standard material and color: See uni Material and Color Overview.

Accessories

Non standard uni AmFlight

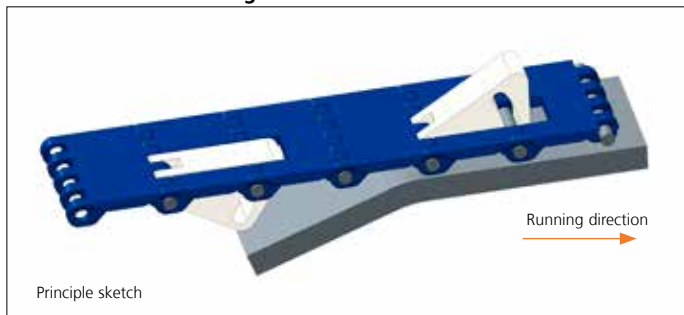

Other non standard option: See uni AmFlight Overview.

Sprocket

No of teeth	Bore size										Overall diameter		Pitch-diameter		Hub-diameter		Dimension A		Dimension B		Single row/One way	Double row/Two way	Molded	Machined
	Pilot bore		1.00		1.18		1.25		1.50															
	mm	in	25.4	30.0	31.8	38.1	40.0	60.0	63.5	90.0	mm	in	mm	in	mm	in	mm	in						
Z06	✓	●	●	●	■	●	■				99.5	3.92	101.6	4.00	65.0	2.56	36.0	1.42	59.3	2.33	✓		✓	
Z08	✓	●	●	●	■	●	■	■			132.9	5.23	132.8	5.23	70.0	2.75	53.3	2.10	74.9	2.94	✓	1✓	✓	
Z10	✓		1●	1●	1●	1■	1■	2■	2■		166.3	6.55	164.4	6.47	170.0 2120.0	2.75 4.72	70.2	2.76	90.7	3.57	✓	✓	✓	
Z12	✓		1●	1●	1●	1■	1■	2■	2■	3■	198.6	7.82	196.3	7.73	170.0 2120.0 3164.0	2.75 4.72 6.45	86.8 86.8	3.42 3.42	106.6 106.6	4.19 4.19	1+2✓	2+3✓	✓	
Z16	✓		2● 1●	2● 1●	2● 1●	2■ 1■	2■ 1■	3■ 1■	2■ 1■	3■	263.8	10.39	260.4	10.25	1150.0 2164.0 3200.0	5.90 6.45 7.87	119.7	4.71	138.7	5.46	1✓	2+3✓	✓	✓

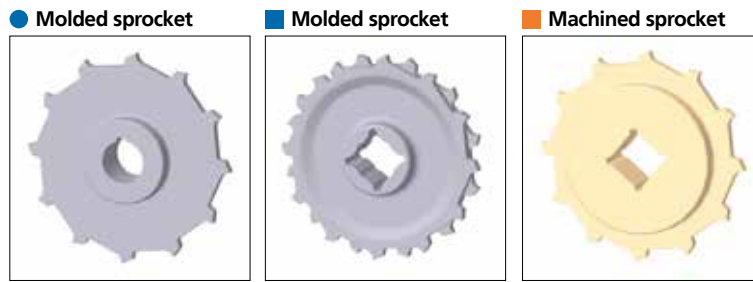

Other sprocket sizes are available upon request.
 Other bore sizes on sprockets are available upon request.
 Round bores are always delivered with keyway.
 Max. load per sprocket shown does not take bore size into account.
 Please also ensure that sufficient size shaft is chosen for corresponding load.

Width of tooth = Single row: 9.5 mm (0.37 in)
 = Double row: 17.8 mm (0.70 in)

Width of One-part sprocket = Single row: 42.3 mm (1.66 in)
 = Double row: 42.3 mm (1.66 in)
 = 3Double row: 50.0 mm (1.96 in)

uni UltraClean Two-Part Sprocket

No. of teeth	Bore size				Overall diameter		Pitch-diameter		Hub-diameter		Dimension A		Dimension B		Single row/One way	Moulded
	in	1.50	1.57	2.36												
	mm	38.1	40.0	60.0	mm	in	mm	in	mm	in	mm	in				
Z8		■	■		132.9	5.23	132.8	5.23	80.0	3.15	53.3	2.10	74.9	2.94	✓	✓
Z10		1■	1■	2■	166.3	6.55	164.4	6.47	126.0 ¹ 118.0 ²	4.96 4.65	70.2	2.76	90.7	3.57	✓	✓
Z12		1■	1■	2■	198.6	7.82	196.3	7.73	126.0 ¹ 118.0 ²	4.96 4.65	86.8	3.42	106.6	4.19	✓	✓

Moulded uni UltraClean TwoPart Sprocket

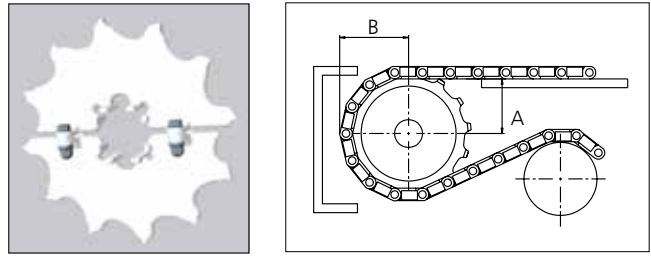

Width of UltraClean two-part sprocket = Single row: 44.0 mm (1.73 in)
 Width of tooth = Single row: 9.5 mm (0.37 in)

uni Retainer Rings: See uni Retainer Ring data sheet.
 For correct sprocket position: See uni Assembly Instructions for uni MPB.
 For more detailed sprocket information. contact Customer Service.

uni MPB 16/2019:03:04

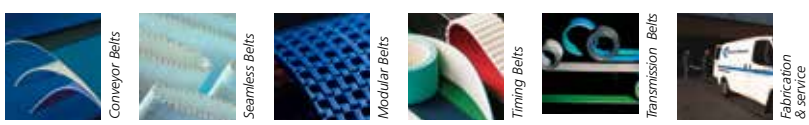

Expert advice, quality solutions and local service for all your belting needs
www.ammeraalbeltech.com

Ammeraal Beltech Modular A/S
 Hjulmagervej 21
 DK-7100 Vejle

T +45 7572 3100
 F +45 7572 3348
 admin@unichains.com
 www.unichains.com

This information is subject to alteration due to continuous development. Ammeraal Beltech will not be held liable for the incorrect use of the above stated information. This information replaces previous information. All activities performed and services rendered by Ammeraal Beltech are subject to general terms and conditions of sale and delivery, as applied by its operating companies.