

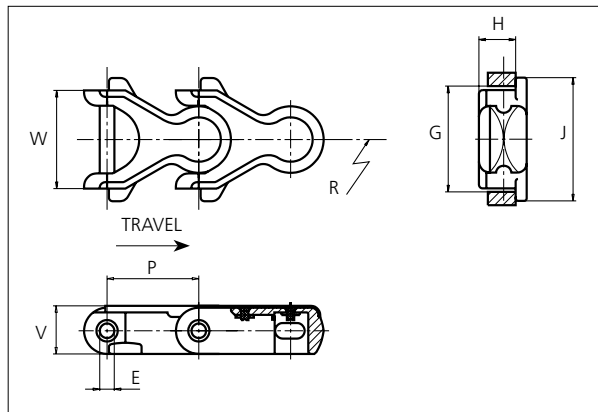

# uni Flex Plastic Chain

Series **uni 1701** Type **Tab R ST**



## uni Flex Plastic Chain

Side flexing chain  
Pitch: 50.0 mm (1.97 in)  
Backflex radius:  
75.0 mm (3.00 in)  
Permissible tensile strength:  
POM material 4000 N (899 lbf)  
Standard shipping lengths:  
boxes of 122 links  
= 6.105 m (20.0 ft)  
Steel top cover: SS430  
thickness 1.0 mm (0.04 in)

E		G		H		J		P		V	
mm	in	mm	in	mm	in	mm	in	mm	in	mm	in
8.0	0.31	56.0	2.20	20.0	0.79	66.7	2.63	50.0	1.97	26.0	1.02

All dimensions are for chains in POM material.

Width (W)		Recommended material & color	Recommended pin material	Weight		Min. radius (R)	
mm	in			kg/m	lb/ft	mm	in
53.3	2.10	POM-LF <b>BR</b>	<b>SS304</b>	-	-	125.0	4.92

Non standard material and color: See uni Material and Color Overview.

Non standard pin material: See uni Material and Color Overview.

NON STANDARD

SIDE FLEXING

PITCH 50.0 MM/1.97 IN

## Sprocket

No of teeth	Pitch diameter		Overall-diameter		Min. ø bore		Max. ø bore		Hub-diameter		Dimension A		Dimension B		Molded PA6 LG	Molded Cast Iron	Machined PA6 N	Machined SS304
	mm	in	mm	in	mm	in	mm	in	mm	in	mm	in	mm	in				
<b>Z8</b>	130.7	5.14	133.0	5.20	20.00	0.80	40.00	1.60	63.00	2.50	47.90	1.90	82.40	3.20	✓	✓	✓	✓
<b>Z10</b>	161.8	6.37	166.1	6.50	20.00	0.80	40.00	1.60	63.00	2.50	64.50	2.50	97.30	3.80	✓	✓	✓	✓
<b>Z12</b>	193.2	7.61	196.0	7.70	20.00	0.80	40.00	1.60	63.00	2.50	80.80	3.20	112.40	4.40	✓	✓	✓	
<b>Z13</b>	208.9	8.22	214.0	8.40	20.00	0.80	40.00	1.60	63.00	2.50	88.90	3.50	120.10	4.70	✓	✓	✓	

Non standard material and color:  
See uni Material and Color Overview.

**Molded sprocket**



**Cast iron sprocket**



**Machined sprocket**

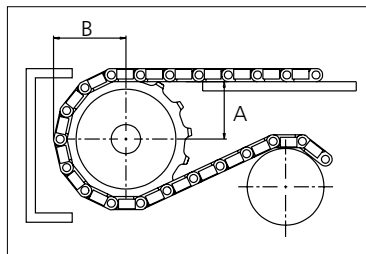

Please ensure that sufficient size shaft and keyway are chosen for corresponding load.

Other sprocket sizes are available upon request

Width of tooth: 11.0 mm/0.43 in

Width of sprocket: 42.3 mm/1.67 in

Width of cast iron sprocket: 41.3 mm/1.63 in

uni Retainer Rings: See uni Retainer Ring data sheet

uni Idler: See uni Idler data sheet

uni 1701 Tab R ST/2021.10.22



Synthetic Belts



Endless Woven Belts

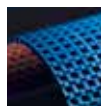

Modular Belts



Engineered Belts



Homogeneous Belts



Fabrication & Service

**Expert advice and quality solutions  
for all your belting needs.**  
ammeraalbeltech.com

**Ammeraal Beltech Modular A/S**  
Hjølsmagervej 21  
DK-7100 Vejle  
T +31 7572 3100

**ammega.com**

This information is subject to alteration due to continuous development. Ammeraal Beltech will not be held liable for the incorrect use of the above stated information. This information replaces previous information. All activities performed and services rendered by Ammeraal Beltech are subject to general terms and conditions of sale and delivery, as applied by its operating companies.

Member of Ammega Group.