

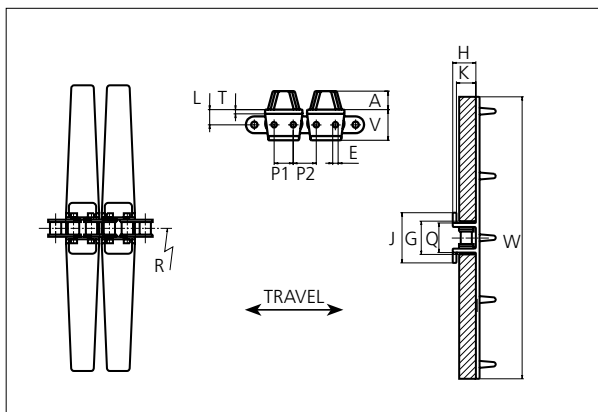

# Snap-On Plastic Chain

Series **uni 1873** Type **SE**



## Snap-On Plastic Chain

Side flexing chain  
Pitch: 19.1 mm (0.75 in)  
Backflex radius: 150.0 mm (5.90 in)  
Permissible tensile strength:  
uni 1873 SE with (SS304) stainless  
steel chain: 2000 N (450 lbf)  
uni 1873 SE with carbon steel  
chain: 4000 N (900 lbf)

Delivery:  
3.05 m (10 ft)  
No. of links/box: 160  
No. of flights/box: 80

NON STANDARD

A		E		G		H		J		K	
mm	in	mm	in	mm	in	mm	in	mm	in	mm	in
14.4	2.14	5.1	0.20	34.9	1.37	25.0	0.98	54.4	2.14	21.0	0.83
L		P1		P2		Q		T		V	
mm	in	mm	in	mm	in	mm	in	mm	in	mm	in
14.3	0.56	18.1	0.71	20.1	0.79	31.8	1.25	4.0	0.16	29.0	1.14

All dimensions are for chains in POM material.

All Snap-On versions can be delivered either with a stainless steel chain (SS304) or a carbon steel chain.

Width (W)			Recommended flight material & color	Recommended chain material	Weight		Min. radius R	
	mm	in			kg/m	lb/ft	mm	in
K1200	304.8	12.00	POM-DI <b>W</b>	Carbon steel	3.5	2.35	457.0	17.99
K1200	304.8	12.00	POM-DI <b>G</b>	SS304 or Carbon steel	3.5	2.35	457.0	17.99

Non standard material and color: See uni Material and Color Overview.

SIDE FLEXING

PITCH 19.1 MM/0.75 IN

Sprocket

No of teeth	Pitch diameter		Hub diameter		Overall width L		Tooth width B		Bore		Machined S1045
	mm	in	mm	in	mm	in	mm	in	mm	in	
Z19	115.7	4.56	80.0	3.15	35.0	1.38	11.7	0.46	16.0	0.63	✓
Z20	121.8	4.79	80.0	3.15	35.0	1.38	11.7	0.46	16.0	0.63	✓
Z25	152.0	5.98	90.0	3.54	40.0	1.57	11.7	0.46	20.0	0.79	✓

Non standard material and color:  
See uni Material and Color Overview.

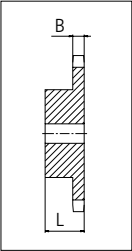

Please ensure that sufficient size shaft and keyway are chosen for corresponding load.

Other sprocket sizes are available upon request.  
uni Retainer Rings: See uni Retainer Ring data sheet.

uni 1873 SE/2016.07.01

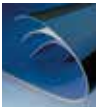

Synthetic Belts



Endless Woven Belts

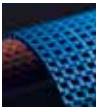

Modular Belts

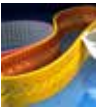

Engineered Belts



Homogeneous Belts



Fabrication & Service

Expert advice and quality solutions  
for all your belting needs.  
ammeraalbeltech.com

Ammeraal Beltech Modular A/S  
Hjulgagervej 21  
DK-7100 Vejle  
T +31 7572 3100

ammera.com

This information is subject to alteration due to continuous development. Ammeraal Beltech will not be held liable for the incorrect use of the above stated information. This information replaces previous information. All activities performed and services rendered by Ammeraal Beltech are subject to general terms and conditions of sale and delivery, as applied by its operating companies.

Member of Ammega Group.