

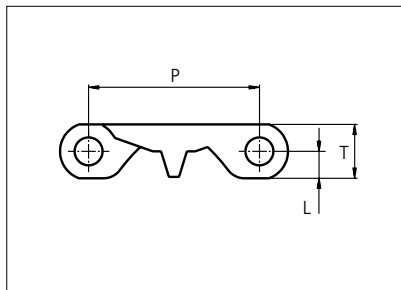

Plastic Modular Belt

Series **uni MPB** Type **22% Open**



Straight running belt
 Nominal pitch: 50.8 mm (2.00 in)
 Surface type: Flat
 Surface opening: 22%
 Backflex radius: 65.0 mm (2.6 in)
 Pin diameter: 8.0 mm (0.31 in)

Belt material & color	PP W		mm	in		mm	in
	Pin material & color	PP W	P (Nominal)	50.8	2.00	T	16.0
L			8.0	0.31	-	-	-

Belt width		Permissible tensile force (Belt/pin material)		Belt weight (Belt/pin material)		*Min. No. drive sprocket per shaft	Number of wear strips (Min. No.)	
		PP/PP		PP/PP			**Carry (pcs)	**Return (pcs)
mm	in	N	lbf	kg/m	lb/ft			
151	5.9	2416	543	1.1	0.73	2	2	2
252	9.9	4032	906	1.8	1.22	2	2	2
302	11.9	4832	1086	2.2	1.46	3	3	2
353	13.9	5648	1270	2.5	1.71	3	3	2
403	15.9	6448	1450	2.9	1.95	3	3	2
453	17.8	7248	1629	3.3	2.19	4	4	2
504	19.8	8064	1813	3.6	2.44	4	4	2
554	21.8	8864	1993	4.0	2.68	4	4	2
604	23.8	9664	2172	4.3	2.92	5	5	3
655	25.8	10480	2356	4.7	3.17	5	5	3
705	27.8	11280	2536	5.1	3.41	5	5	3
755	29.7	12080	2716	5.4	3.65	6	6	3
806	31.7	12896	2899	5.8	3.90	6	6	3
856	33.7	13696	3079	6.2	4.14	6	6	3
906	35.7	14496	3259	6.5	4.38	7	7	4
957	37.7	15312	3442	6.9	4.63	7	7	4
1007	39.6	16112	3622	7.3	4.87	7	7	4
1057	41.6	16912	3802	7.6	5.11	8	8	4
1108	43.6	17728	3985	8.0	5.36	8	8	4
1158	45.6	18528	4165	8.3	5.60	8	8	4
1208	47.6	19328	4345	8.7	5.85	9	9	5

General belt tolerance is +0/-0.4% at 23°C/73°F and 50% RH. For exact belt width contact Customer Service.

*Max. Load per Drive Sprocket. Belt material: PP with snub roller 2000 N (450 lbf) without snub roller 1250 N (281 lbf)

**Max. Spacing between wear strips, Carry: 152.0 mm (6.00 in) ; Return: 304.0 mm (12.00 in).



This Core Range datasheet represents our most valued products. For more options see our uni MPB standard range datasheets.

CORE RANGE

STRAIGHT RUNNING

PITCH 50.8 MM/2.00 IN

Sprocket

No of teeth	Bore size				Overall diameter		Pitch diameter		Hub diameter		Dimension A		Dimension B		Single row/One way	Molded	PA6 LG
	Pilot bore	in	1.57	2.36													
		mm	40.0	60.0	mm	in	mm	in	mm	in	mm	in					
Z08	✓		■		132.9	5.23	132.8	5.23	70.0	2.75	53.3	2.10	74.9	2.94	✓	✓	
Z10	¹ ✓		¹ ■	² ■	166.3	6.55	164.4	6.47	¹ 70.0 ² 120.0	¹ 2.75 ² 4.72	70.2	2.76	90.7	3.57	✓	✓	
Z12	¹ ✓		¹ ■	² ■	198.6	7.82	196.3	7.73	¹ 70.0 ² 120.0	¹ 2.75 ² 4.72	86.8	3.42	106.6	4.19	✓	✓	

Molded sprocket



Width of sprocket = Single row: 42.3 mm (1.66 in)
Width of tooth = Single row: 9.5 mm (0.37 in)

Max. load per sprocket shown does not take bore size into account.

uni UltraClean Two-Part Sprocket

No. of teeth	Bore size				Overall diameter		Pitch-diameter		Hub-diameter		Dimension A		Dimension B		Single row/One way	Moulded	PA6 W
	in	1.50	1.57	2.36													
	mm	38.1	40.0	60.0	mm	in	mm	in	mm	in	mm	in					
Z8		■	■		132.9	5.23	132.8	5.23	80.0	3.15	53.3	2.10	74.9	2.94	✓	✓	
Z10		¹ ■	¹ ■	² ■	166.3	6.55	164.4	6.47	¹ 126.0 ² 118.0	¹ 4.96 ² 4.65	70.2	2.76	90.7	3.57	✓	✓	
Z12		¹ ■	¹ ■	² ■	198.6	7.82	196.3	7.73	¹ 126.0 ² 118.0	¹ 4.96 ² 4.65	86.8	3.42	106.6	4.19	✓	✓	

Moulded uni UltraClean TwoPart Sprocket

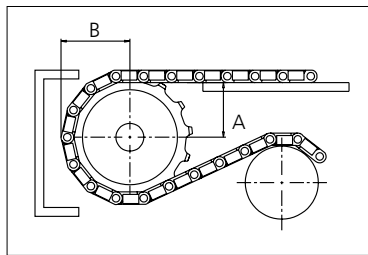

Width of UltraClean Two-part sprocket = Single row: 44.0 mm (1.73 in)
Width of UltraClean Two-part sprocket, tooth = Single row: 9.5 mm (0.37 in)

uni Retainer Rings: See uni Retainer Ring data sheet.
For correct sprocket position: See uni Assembly Instructions for uni MPB.
For more detailed sprocket information, contact Customer Service.

This Core Range datasheet represents our most valued sprockets.
For more sprocket options see our uni MPB standard range datasheets.

uni MPB 22% Open/2019.03.04

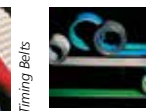
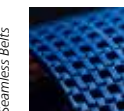

Expert advice, quality solutions and local service for all your belting needs
www.ammeraalbeltech.com

Ammeraal Beltech Modular A/S
Hjulmagervej 21
DK-7100 Vejle

T +45 7572 3100
F +45 7572 3348
admin@unichains.com
www.unichains.com

This information is subject to alteration due to continuous development. Ammeraal Beltech will not be held liable for the incorrect use of the above stated information. This information replaces previous information. All activities performed and services rendered by Ammeraal Beltech are subject to general terms and conditions of sale and delivery, as applied by its operating companies.