

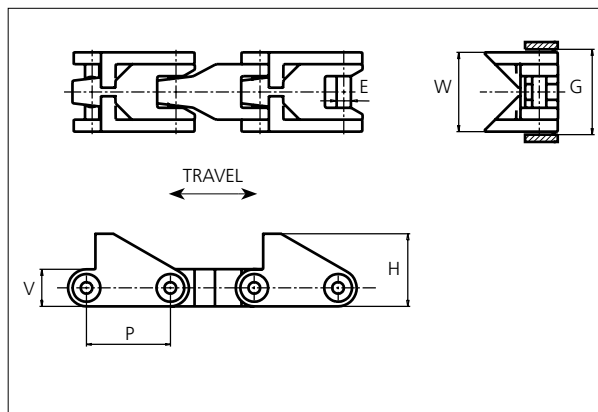

# uni Flex Plastic Chain

Series **uni 2600** Type **CV**



## uni Flex Plastic Chain

Straight running  
Pitch: 63.5 mm (2.50 in)  
Backflex radius: 75.0 mm (3.00 in)  
Permissible tensile strength:  
POM material: 4500 N (1012 lbf)  
The product supports can be  
placed no closer than every other  
pitch (127.0 mm or 5.00 in)  
Standard shipping lengths:  
boxes of 96 links  
= 6.096 m (20.0 ft)

E		G		H		P		V	
mm	in	mm	in	mm	in	mm	in	mm	in
11.0	0.43	64.0	2.52	55.0	2.17	63.5	2.50	28.4	1.12

All dimensions are for chains in POM material.

Nominal width (W)		Recommended Material & color	Recommended Pin material	Weight	
mm	in			kg/m	lb/ft
61.5	2.42	POM-D <b>W</b>	<b>SS431</b>	2.1	1.41

Non standard material and color: See uni Material and Color Overview.

Non standard pin material: See uni Material and Color Overview.

NON STANDARD

STRAIGHT RUNNING

PITCH 63.5 MM/2.50 IN

## Sprocket

No of teeth	Pitch diameter		Overall-diameter		Min. ø bore		Max. ø bore		Hub-diameter		Dimension A		Dimension B		LG	Cast iron	SS304
	mm	in	mm	in	mm	in	mm	in	mm	in	mm	in	mm	in	Molded PA6	Molded	Machined
<b>Z6</b>	127.0	5.00	128.0	5.04	20.0	0.79	40.0	1.57	63.0	2.48	40.8	1.61	78.1	3.07	✓	✓	
<b>Z8</b>	165.9	6.53	168.9	6.65	20.0	0.79	50.0	1.97	73.5	2.89	62.5	2.46	97.5	3.84	✓	✓	✓
<b>Z10</b>	205.5	8.09	210.5	8.29	20.0	0.79	50.0	1.97	73.5	2.89	83.5	3.29	117.2	4.61	✓	✓	
<b>Z11</b>	225.4	8.87	231.4	9.11	20.0	0.79	50.0	1.97	73.5	2.89	93.9	3.70	127.1	5.00	✓	✓	

**Machined sprocket**



**Cast iron sprocket**



**SS304 sprocket**

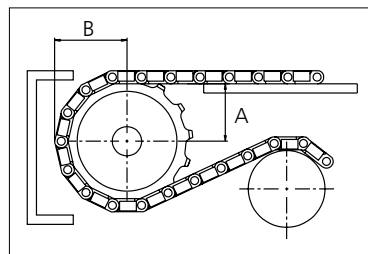

Please ensure that sufficient size shaft and keyway are chosen for corresponding load.

Other sprocket sizes are available upon request  
 Width of tooth: 11.0 mm/0.43 in  
 Width of sprocket: 42.3 mm/1.66 in  
 Width of cast iron sprocket: 41.3 mm/1.63 in  
 uni Retainer Rings: See uni Retainer Ring data sheet

Non standard material and color:  
 See uni Material and Color Overview.

uni 2600 CV/2021.08.23



Synthetic Belts



Endless Woven Belts

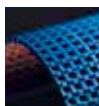

Modular Belts



Engineered Belts



Homogeneous Belts



Fabrication & Service

**Expert advice and quality solutions  
 for all your belting needs.**  
 ammeraabeltech.com

**Ammeraal Beltech Modular A/S**  
 Hjulmagervej 21  
 DK-7100 Vejle  
 T +31 7572 3100

**ammega.com**

This information is subject to alteration due to continuous development. Ammeraal Beltech will not be held liable for the incorrect use of the above stated information. This information replaces previous information. All activities performed and services rendered by Ammeraal Beltech are subject to general terms and conditions of sale and delivery, as applied by its operating companies.

Member of Ammega Group.