

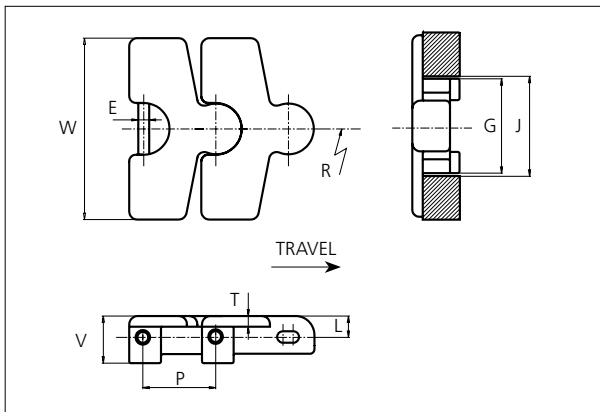

uni Flex Plastic Chain

Series **uni 3000** Type -



uni Flex Plastic Chain

Side flexing chain
Pitch: 80.1 mm (3.15 in)
Backflex radius:
200.0 mm (8.00 in)
Permissible tensile strength:
POM material
11000 N (2473 lbf)

Standard shipping lengths:
boxes of 38 links
= 3.044 m (10.0 ft)

E		G		J		L		P		T		V	
mm	in	mm	in	mm	in	mm	in	mm	in	mm	in	mm	in
12.1	0.48	104.0	4.09	110.0	4.33	28.4	1.12	80.1	3.15	9.0	0.35	52.0	2.05

All dimensions are for chains in POM material.

Width (W)		Recommended Material & color	Recommended Pin material	Weight		Min radius R	
mm	in			kg/m	lb/ft	mm	in
200.0	7.87	POM-D W POM-D G	SS304	5.8	3.90	600.0	23.62

Non standard material and color: See uni Material and Color Overview.



Non standard pin material: See uni Material and Color Overview.

NON STANDARD

SIDE FLEXING

PITCH 80.1 MM/3.15 IN

Sprocket

No of teeth	Pitch diameter		Overall-diameter		Min. ø bore		Max. ø bore		Hub-diameter		Dimension A		Dimension B		Machined  PAG
	mm	in	mm	in	mm	in	mm	in	mm	in	mm	in	mm	in	
Z10	226.4	8.91	227.6	8.96	20.0	0.79	50.0	1.97	73.5	2.89	116.0	4.57	137.6	5.42	

Non standard material and color:
See uni Material and Color Overview.

Machined sprocket

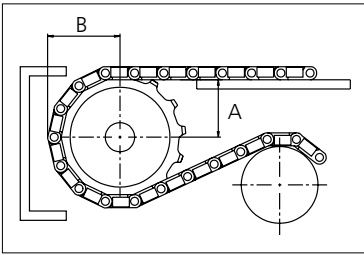

Please ensure that sufficient size shaft and keyway are chosen for corresponding load.

Other sprocket sizes are available upon request
Width of tooth: 15.0 mm/0.60 in
Width of sprocket: 42.3 mm/1.66 in
uni Retainer Rings: See uni Retainer Ring data sheet

uni 3000/2016.06.23

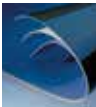

Synthetic Belts



Endless Woven Belts

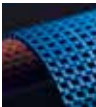

Modular Belts

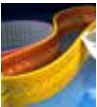

Engineered Belts



Homogeneous Belts



Fabrication & Service

Expert advice and quality solutions
for all your belting needs.
ammeraalbeltech.com

Ammeraal Beltech Modular A/S
Hjulumagervej 21
DK-7100 Vejle
T +31 7572 3100

ammega.com

This information is subject to alteration due to continuous development. Ammeraal Beltech will not be held liable for the incorrect use of the above stated information. This information replaces previous information. All activities performed and services rendered by Ammeraal Beltech are subject to general terms and conditions of sale and delivery, as applied by its operating companies.

Member of Ammega Group.