

ZipLink® is a breakthrough in belting design that combines cover materials with a structured link mesh that can be easily spliced at any length into a continuous belt without the need for special tools, presses or other equipment.

The ZipLink® construction eliminates points of weakness because there is no loss of strength in the splice area, making the belts stronger so they last longer than belts of other seamed or fused materials.

ZipLink® provides long life and flexibility for multiple applications. The belts can easily and quickly be changed without accruing significant downtime or expensive overtime. After converting to ZipLink®, time and personnel required to change belts may be reduced by more than half.



Complete toolbox available, including instruction CD

Working instruction

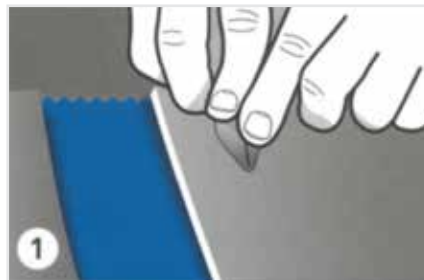

Score the back and lubricate the pin.



Pop the pin out at 1.5 cm from the edge.

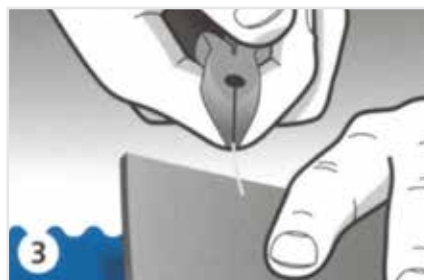

Gently pull the pin out using pliers.



Carefully cut the top cover.



Press the ends back together firmly.



Pass the wire through and cut the excess.

Local Contacts

Australia

T +61 3 9555 7922
info-au@ammeraalbeltech.com
www.rydell.com.au

Austria

T +43 171728 133
info-de@ammeraalbeltech.com
www.ammeraalbeltech.at

Belgium

T +32 2 466 03 00
info-be@ammeraalbeltech.com
www.ammeraalbeltech.be

Canada

T +1 905 890 1311
info-ca@ammeraalbeltech.com
www.ammeraalbeltech.com

Chile

T +56 2 233 12900
info-cl@ammeraalbeltech.com
www.ammeraalbeltech.cl

China

T +86 512 8287 2709
info-cn@ammeraalbeltech.com
www.ammeraalbeltech.com.cn

Czech Republic

T +420 567 117 211
info-cz@ammeraalbeltech.com
www.ammeraalbeltech.cz

Denmark

T + 45 7572 3100
info-dk@ammeraalbeltech.com
www.unichains.com

Finland

T +358 207 911 400
info-fi@ammeraalbeltech.com
www.ammeraalbeltech.fi

France

T +33 3 20 90 36 00
info-fr@ammeraalbeltech.com
www.ammeraalbeltech.fr

Germany

T +49 4152 937-0
info-de@ammeraalbeltech.com
www.ammeraalbeltech.de

Hungary

T +36 30 311 6099
info-hu@ammeraalbeltech.com
www.ammeraalbeltech.hu

India

T +91 44 265 34 244
info-in@ammeraalbeltech.com
www.ammeraalbeltech.com

Italy

T +39 051 660 60 06
info-it@ammeraalbeltech.com
www.ammeraalbeltech.it

Luxembourg

T +352 26 48 38 56
info-lu@ammeraalbeltech.com
www.ammeraal-beltech.lu

Malaysia

T +60 3 806 188 49
info-my@ammeraalbeltech.com
www.ammeraalbeltech.com

Netherlands

T +31 72 57 51212
info-nl@ammeraalbeltech.com
www.ammeraalbeltech.nl

Poland

T +48 32 44 77 179
info-pl@ammeraalbeltech.com
www.ammeraalbeltech.com

Portugal

T +351 22 947 94 40
info-pt@ammeraalbeltech.com
www.ammeraalbeltech.pt

Singapore

T +65 62739767
info-sg@ammeraalbeltech.com
www.ammeraalbeltech.com

Slovakia

T +421 2 55648541-2
info-sk@ammeraalbeltech.com
www.ammeraalbeltech.sk

South Korea

T +82 31 448 3613-7
info-kr@ammeraalbeltech.com
www.ammeraalbeltech.co.kr

Spain

T +34 93 718 3054
info-es@ammeraalbeltech.com
www.ammeraalbeltech.es

Sweden

T +46 44 780 3010
info-se@ammeraalbeltech.com
www.ammeraalbeltech.se

Switzerland

T +41 55 2253 535
info-ch@ammeraalbeltech.com
www.ammeraalbeltech.ch

Thailand

T +66 2 902 2604-13
info-th@ammeraalbeltech.com
www.ammeraalbeltech.com

United Kingdom

T +44 1992 500550
info-uk@ammeraalbeltech.com
www.ammeraalbeltech.co.uk

United States

T +1 847 673 6720
info-us@ammeraalbeltech.com
www.ammeraalbeltech.com

Vietnam

T +84 8 376 562 05
info-vn@ammeraalbeltech.com
www.ammeraalbeltech.com.vn

Global Headquarters:

Ammeraal Beltech Holding B.V.
P.O. Box 38
1700 AA Heerhugowaard
The Netherlands

T +31 (0)72 575 1212
F +31 (0)72 571 6455

info@ammeraalbeltech.com
www.ammeraalbeltech.com

Expert advice, quality solutions
and local service
for all your belting needs

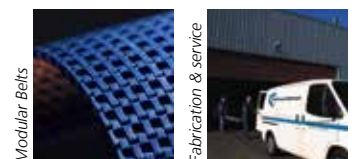
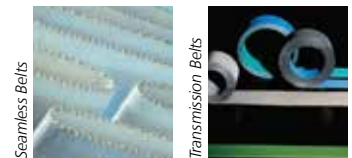
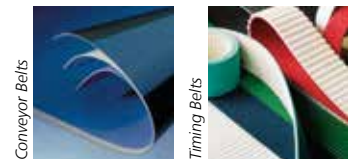

... and 150 more service contact points at www.ammeraalbeltech.com



ZipLink® Belts

Win Your Race at the Pit Stop!

ZipLink® - Increase your production time



Ammeraal Beltech is a leading manufacturer of process and conveyor belting with an established reputation for developing innovative solutions for belting applications.

Working closely with OEMs and end users Ammeraal Beltech has developed a range of ZipLink® Belts: a special design link fabric in combination with top covers giving superior performance. Main benefit is the striking increase of your production time.



ZipLink® Belts:

- **Minimize replacement time on site by 75%**
- Eliminate splice failures
- Eliminate damages to transported products
- Eliminate damages to machine parts (drums, slider beds) due to mechanical fasteners

ZipLink®, ideal for whatever application where belt replacement time is an issue, for example:

- » **Cardboard industry**
bridge raising and bridge, slitting, cross cutting, box folding, stacking, delivery
- » **Wood processing**
grinding, sanding, polishing, braking, sawing, painting, pre-compressing
- » **Tyre industry**
uncured rubber transport, general process and handling
- » **Airports & logistics**
scanning, check in, collectors, inclined transport, airplane loading
- » **Tobacco processing**
conditioning, weighing, transport
- » **Magnetic conveyors**
- » **Food applications**



Belts that join instantly

Easy, no specific training required

AMMERAAL BELTECH ZIPLINK® BELT RANGE	<ul style="list-style-type: none"> » Shortest production downtime » Reduced maintenance time and cost » Extended belt service life » Ideal for difficult locations 	Increased production time
	<ul style="list-style-type: none"> » Protects both product and conveyor from being damaged » Extra high stability allows for easier tracking » Safe on-site installation, no heavy equipment needed » No loss of strength in the joint area 	Operational safety
	<ul style="list-style-type: none"> » Low friction bottom version helps reduce energy consumption due to the absence of splice areas 	Less energy consumption
	<ul style="list-style-type: none"> » Strongest in-house splicing; no outside fitters required » No need for any special tools or presses » Possible repair of damaged belt sections 	Economical use
	<ul style="list-style-type: none"> » Choice of top cover materials tuned to the application » ZipLink® Belts have a proven track record worldwide 	Proven technology

ZipLink® is an innovative belt range which is specially designed to offer benefits in a variety of different industries. Quick and simple installation or repair help to lower costs and reduce downtime. The design allows for repair or replacement of just small sections of the belt.





FAST & EASY
SPLICING

with ZipLink® Belts



The largest range of covers ... and we can make your specific belt on demand

Selection of Range ZipLink® Belts

Article no.	Nomenclature						Thickness [mm]	Hardness top cover [shore]	Min. pulley dia. flexing [mm]	Min. pulley dia. back flexing [mm]	Temperature min. [°C]	Temperature max. [°C]
514927	Elastoflex	EZP	10/1	0 +	A19	beige / 50 Sh	9.0	50A	100	120	-15	80
560165	Fabric	EZP	10/1	01 +	0	black	3.6	-	64	100	-40	121
583040	Fabric	EZP/C	10/2	0 +	0	white FG	3.9	-	80	80	-15	90
583010	Flexam	EZP	10/1	0 +	10	black M2 FR	3.5	80A	50	80	-15	80
583050	Flexam	EZP	10/1	0 +	A20	black FR	8.4	65A	100	150	-15	80
583055	Flexam	EZP	10/1	0 +	A66	black FR	8.8	65A	100	150	-15	80
583056	Felt	EZP	10/1	0 +	FE	black	4.3	-	100	150	-10	100
560124	Nitrile	EZP	10/1	01 +	C57	white FG	4.0	60A	75	100	-18	121
560119	Nitrile	EZP	10/1	01 +	08	white CR FG HR	3.4	60A	75	100	-18	121
560121	Nitrile	EZP	10/1	01 +	C37	brown	6.3	50A	75	125	-18	121
560141	Nitrile BX	EZP	10/1	0 +	05	blue FG	3.4	75A	50	50	-18	121
560136	Nitrile BX	EZP	10/1	0 +	C37 (NI)	blue	6.2	70A	75	120	-18	121
560120	Nitrile BX	EZP	10/1	01 +	05	blue	2.6	70A	50	75	-18	121
560110	Nitrile BX	EZP	10/1	01 +	C37 (NI)	blue	6.3	70A	75	120	-18	121
583020	Nonex	EZP	10/1	0 +	10	white FG	3.5	65A	50	80	-15	80
560122	NR	EZP	10/1	01 +	32	red	5.1	40A	100	125	-40	121
560111	NR	EZP	10/1	01 +	C37	natural CR	6.3	40A	75	100	-40	121
560116	NR	EZP	10/1	01 +	C52	tan CR	7.2	45A	100	175	-40	121
560162	Silam	EZP	10/1	01 +	05	white CR HD FG HR OR	2.3	-	76	152	-60	200
560173	Silam	EZP	10/1	01 +	03	red CR HD HR OR	5.3	-	101	101	-40	176
560191	Teflon	EZP	10/1	0 +	01	grey FG HR	3.4	-	75	-	-18	150
514615	Pletex	EZP	10/1	0 +	30	red	6.0	35A	60	80	-15	80
560127	SBR	EZP	10/1	0 +	C37	black	5.3	45A	75	100	-40	121
560129	SBR	EZP	10/1	01 +	C37	black CR	6.3	45A	75	110	-40	121

CR = cold resistant, FG = foodgrade, FR = flame retardant, HR = heat resistant, HD = hydrolysis resistant, OR = oil resistant

Easy replacement of the complete belt or of small sections in the event of damage.



Achieve considerable cost savings: easy to use tooling kit and no specialised outside fitters required.